



COLLETTORI CON VALVOLE A SFERA COLLETTORI CON VALVOLE A SFERA

Serie NINO

Descrizione / Description

Collettori "NINO" con attacchi 1/2"x16 e valvola a sfera.

Manifold "NINO" with connections 1/2"x16 and ball valve.

Funzione / Function

I collettori di distribuzione "NINO" sono generalmente utilizzati nelle reti di distribuzione di acqua calda e fredda. Grazie alla loro configurazione permettono l'alimentazione in parallelo delle utenze per acqua calda e/o fredda riducendo al minimo le perdite di carico.

I collettori sono prodotti in conformità alle normative in materia e sono certificati relativamente alla composizione chimica dei materiali impiegati ed a livello dimensionale.

The distribution manifolds "NINO" are typically used for hot and cold water distribution.

Due to the configuration they may be used to distribute cold/hot water in parallel reducing at minimum the pressure drop. The manifolds are produced according to the relevant rules and are certified for material chemical composition and dimensional request.

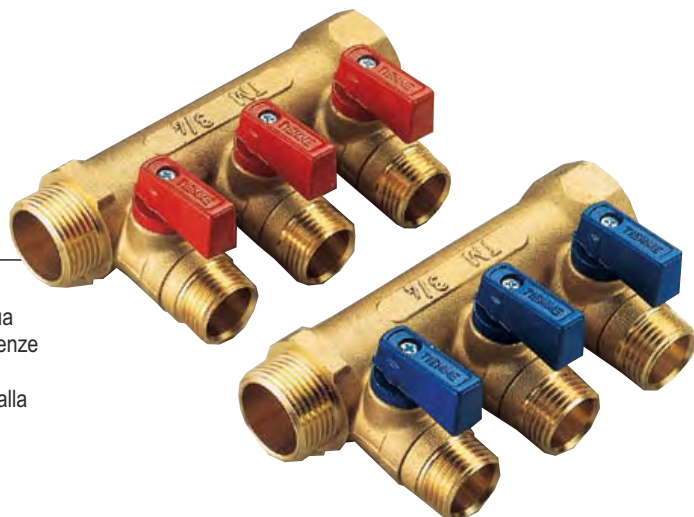

Caratteristiche Tecniche

Temperatura max di esercizio: 110°C
 Temperatura min di esercizio: -20°C
 Pressione max di esercizio: 16 bar
 Filettature : maschio UNI ISO 7/1 R conica
 femmina UNI ISO 7/1 Rp cilindrica

Technical Features

Maximum temperature: 110°C
 Minimum temperature: -20°C
 Maximum operating pressure: 16 bar
 Threads: male UNI ISO 7/1 R conical
 female UNI ISO 7/1 Rp parallel

Dimensioni / Dimensions

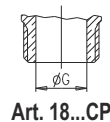
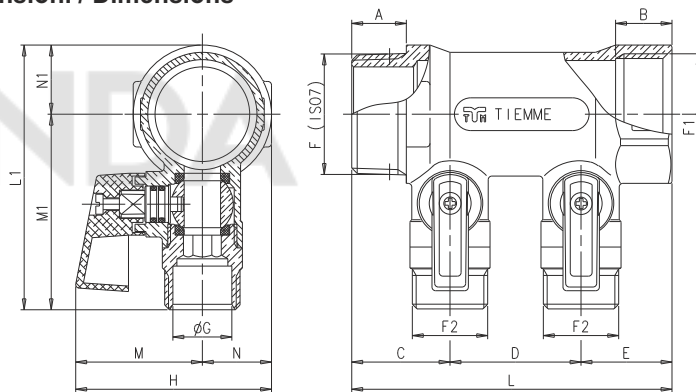

Descrizione	Materiale	Trattamento
Corpo	Ottone CW617N - EN12165	-
Sfera	Ottone CW617N - EN12164	Cromata
Stelo	Ottone CW617N - EN12164	-
O-rings	Gomma nitrilica NBR	-
Guarnizioni laterali	P.T.F.E.	-
Leva	Alluminio	Verniciata rossa o blu
Vite	Acciaio	-

Description	Material	Treatment
Body	CW617N-EN12165 brass	-
Ball	CW617N-EN12164 brass	Chrome plated
Stem	CW617N-EN12164 brass	-
O-rings	Nitrile Rubber NBR	-
Side washers	P.T.F.E.	-
Handle	Aluminium	Painted red or blue
Screw	Steel	-

Certificazioni Certifications



Codice/Code	Size	A	B	C	D	E	F	F1	F2	G	H	L	L1	M	M1	N	N1
1822G160402 1820002	3/4"	16,5	16,5	28,5	36,0	27,0	3/4"	3/4"	1/2"	16,2	51,0	91,5	66,5	35,0	50,5	16,0	16,0
1823G160403 1820001	3/4"	16,5	16,5	28,5	36,0	27,0	3/4"	3/4"	1/2"	16,2	51,0	127,5	66,5	35,0	50,5	16,0	16,0
1824G160404 1820016	3/4"	16,5	16,5	28,5	36,0	27,0	3/4"	3/4"	1/2"	16,2	51,0	163,5	66,5	35,0	50,5	16,0	16,0
1832G160402 1820006	1"	17,0	17,0	29,0	36,0	27,0	1"	1"	1/2"	16,2	54,0	92,0	72,5	35,0	53,5	19,0	19,0
1833G160403 1820005	1"	17,0	17,0	29,0	36,0	27,0	1"	1"	1/2"	16,2	54,0	128,0	72,5	35,0	53,5	19,0	19,0
1822G140402CP 1820009	3/4"	16,5	16,5	28,5	36,0	27,0	3/4"	3/4"	1/2"	14,0	51,0	91,5	66,5	35,0	50,5	16,0	16,0
1823G140403CP 1820008	3/4"	16,5	16,5	28,5	36,0	27,0	3/4"	3/4"	1/2"	14,0	51,0	127,5	66,5	35,0	50,5	16,0	16,0
1832G140402CP 1820014	1"	17,0	17,0	29,0	36,0	27,0	1"	1"	1/2"	14,0	54,0	92,0	72,5	35,0	53,5	19,0	19,0
1833G140403CP 1820013	1"	17,0	17,0	29,0	36,0	27,0	1"	1"	1/2"	14,0	54,0	128,0	72,5	35,0	53,5	19,0	19,0



Diagrammi portata/perdita di carico
Flow/pressure drop diagrams

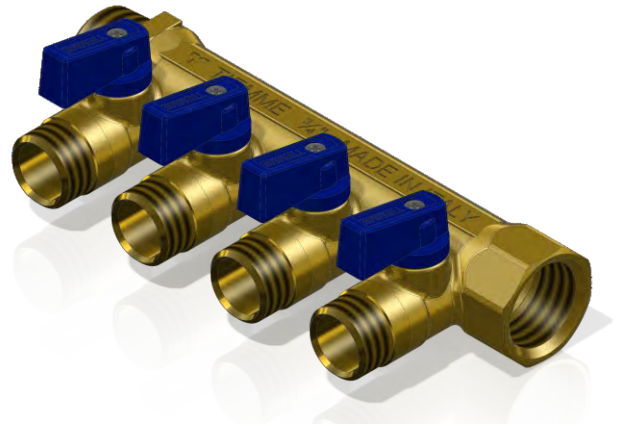
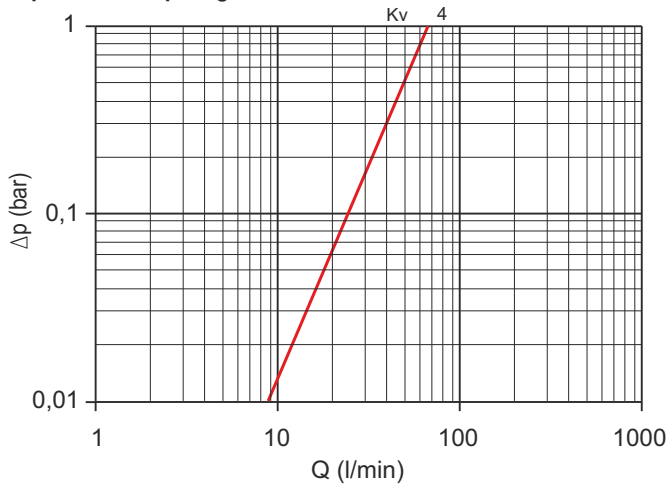

Guida alle connessioni
Fitting guide

Art. 1822-1823-1824-1832-1833

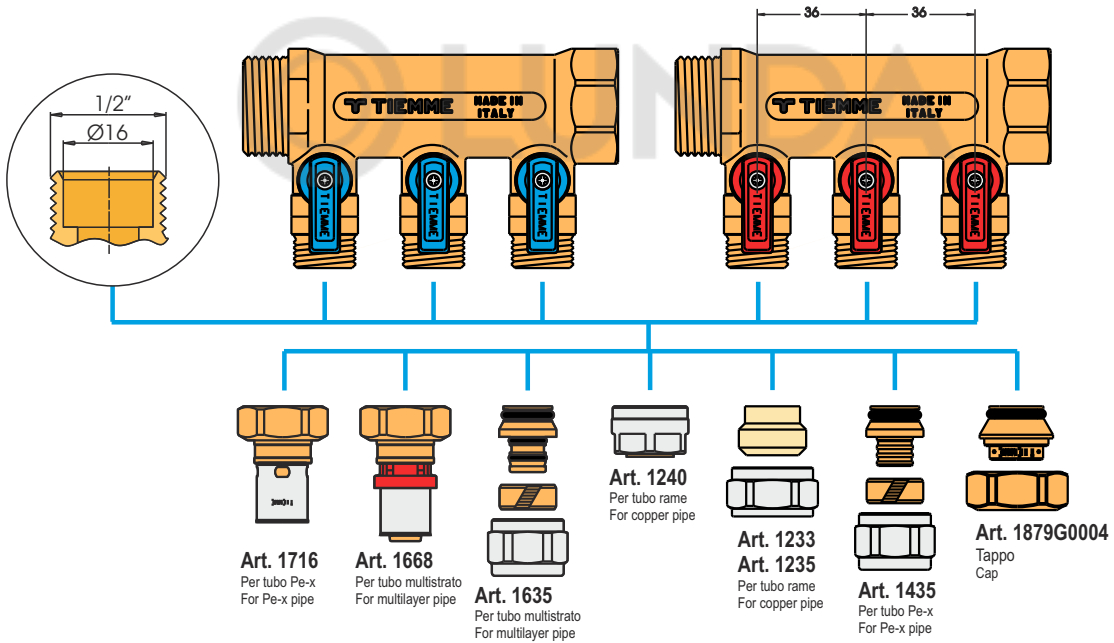

Art. 1822CP-1823CP-1832CP-1833CP

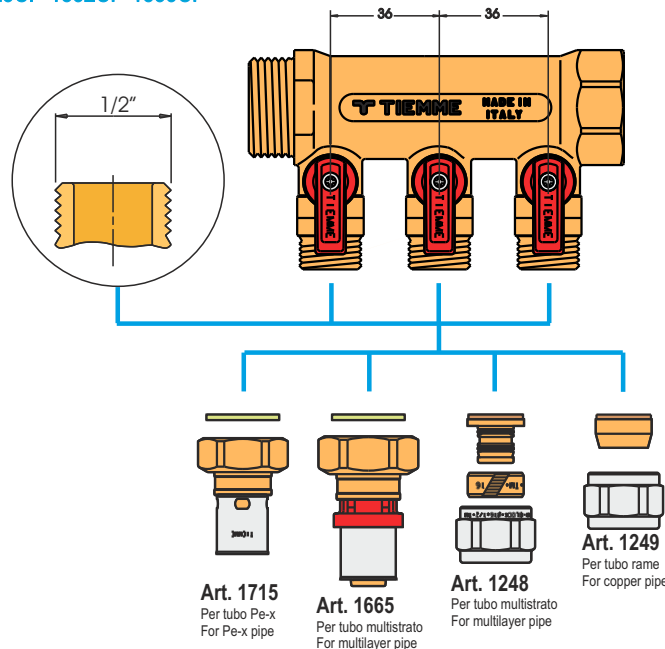



Cassette utilizzabili
Boxes used

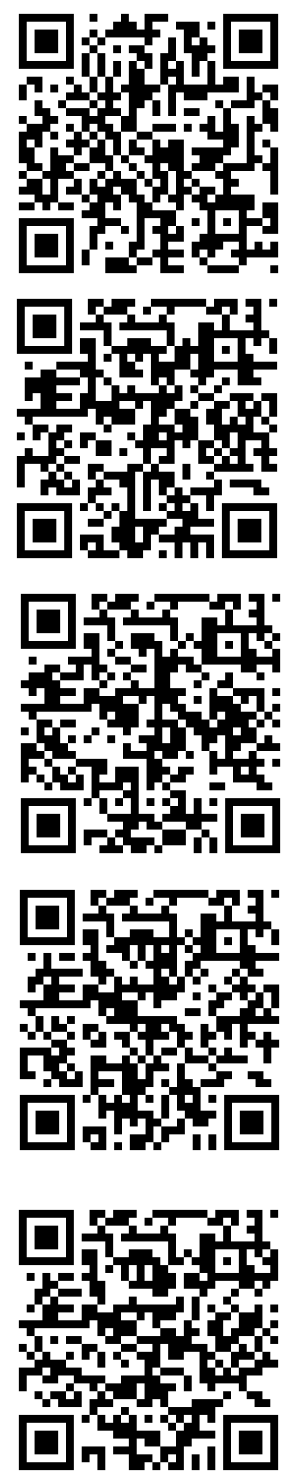
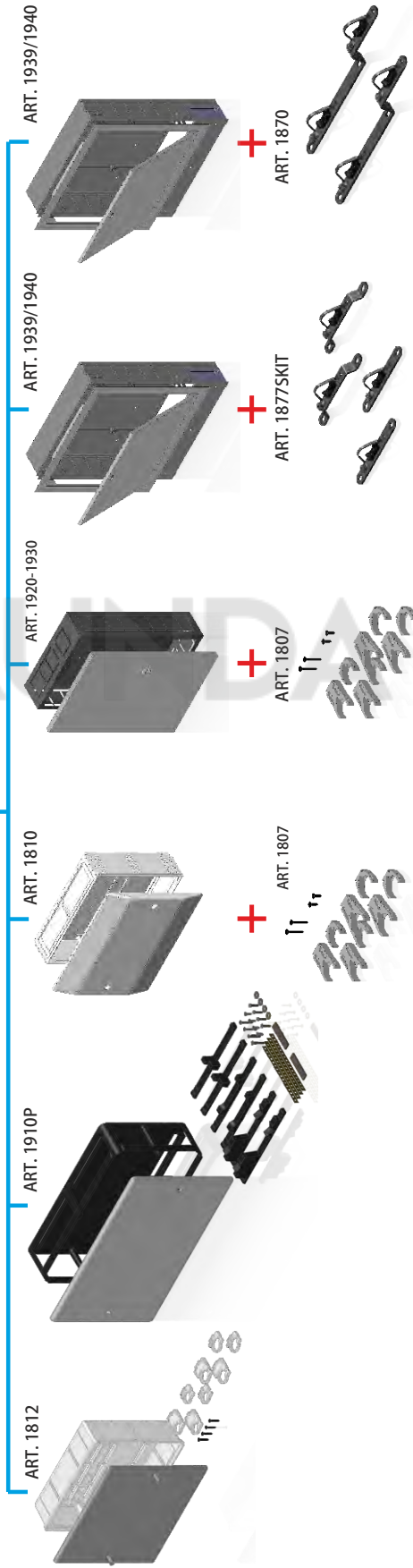
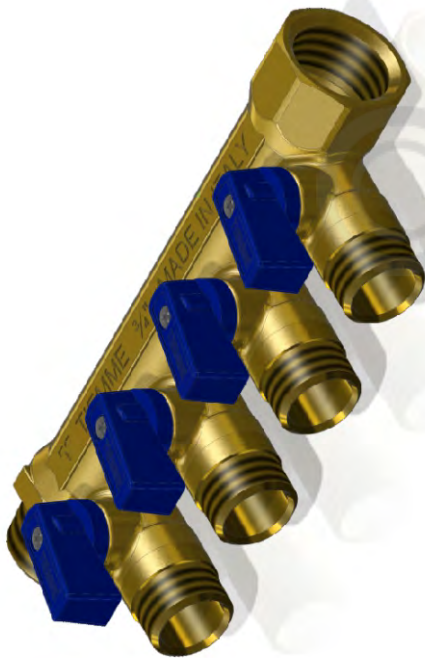

TIEMME Raccorderie S.p.A.
Via Cavallera 6/A (Loc. Barco) - 25045 Castegnato (Bs) - Italy
Tel +39 030 2142211 R.A. - Fax +39 030 2142206
info@tiemme.com - www.tiemme.com